

**Phase 4**

SECTION AFTER  
FIRST PAINTING  
STAGE MADE BY  
ANAPHORESIS

**Phase 5**

SECTION  
AFTER SECOND  
PAINTING STAGE



**PAINTING AND FINISHING PHASES**

The manufacturer reserves the right to make any modifications deemed necessary without prior notification.



Uff. Pub. Fondital - CTC 03 P.400 - 03 Gennaio 2017 (500 - 09/2017)

**Calidor 80**

Die cast aluminium radiators



New weldless base assembled  
by thermoelectric joining  
technology

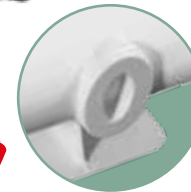

**EN**

www.fondital.com

**Phase 3**

WASHING AND  
CHEMICAL  
TREATMENT  
OF THE SURFACES

**Phase 1**  
UNMACHINED  
SECTION

**Phase 2**  
MACHINED  
SECTION



FONDITAL S.p.A.  
Via Cerreto, 40 - 25079 VOBARNO (Brescia) Italy  
Tel.: +39 0365 878.31 - Fax: +39 0365 878.304  
E-mail: info@fondital.it - Web: www.fondital.com

COMPANY WITH  
QUALITY SYSTEM  
CERTIFIED BY DNV GL  
= ISO 9001 =

**Choose CALIDOR80, choose the evolution of heating:**

CALIDOR80 is the result of a research project aimed at optimizing radiator performance in order to offer a product with excellent mechanical properties and high thermal conductivity.

Designed to allow installation in any premises and blend in with any interior style, CALIDOR80, entirely made of aluminium alloy, delivers excellent heating performance for homes and commercial buildings.

Model	Depth	Height	Centre distance	Length	Connection diameters	Water capacity	Heat output $\Delta T$ 50K	Heat output $\Delta T$ 30K	Exponent	Coefficient
	mm	mm	mm	mm	inches	litres/sect.	W/sect.	W/sect.	n	$K_m$
<b>CALIDOR80 B2 500/80</b>	77	556	500	80	G1	0,24	<b>100,2</b>	51,8	1,2935	0,6358
<b>CALIDOR80 B2 600/80</b>	77	658	600	80	G1	0,28	<b>114,9</b>	59,8	1,2774	0,7765
<b>CALIDOR80 B2 700/80</b>	77	758	700	80	G1	0,39	<b>132,7</b>	68,7	1,2878	0,8608
<b>CALIDOR80 B2 800/80</b>	77	858	800	80	G1	0,42	<b>147,1</b>	75,6	1,3031	0,8984

**Maximum working pressure: 1600 kPa (16 bar)**

Characteristic equation of the model  $\Phi = K_m \Delta T^n$ .

The thermal efficiency values shown comply with the European Standard EN 442-1:2014 and are certified by the MRT Lab of the Milan Polytechnic, notified body no. 1695.

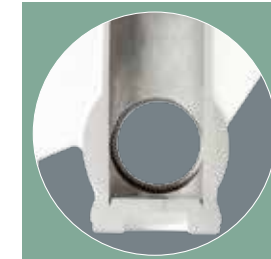

Sectional view of weldless base with thermoelectric joining technology



New radiator base joined by thermoelectric technology

Fondital presents its new radiators with weldless base, assembled with an exclusive thermoelectric joining technology. An environmentally friendly solution.



Thermoelectric process, a PATENT PENDING technology, ensures a stable joint between the aluminium die-cast section and its base. Metal in the joint area is absolutely uniform and the two components are perfectly integrated into each other.



Thermoelectric joining technology is carried out at controlled temperatures that prevent spatter and porosity. The result is a radiator that is as solid as a 100% single piece in aluminium, even more sturdy and reliable than ever.

**Other ADVANTEGES of the thermoelectric joining process:**

- ✓ No build-up of sludge in the bottom of the radiator.
- ✓ Perfect finish with no internal defects.
- ✓ Better visual appearance, no sharp burrs.
- ✓ Higher mechanical resistance.
- ✓ Environmentally friendly process, no waste of material.

**Choose CALIDOR80 radiator and enjoy all its advantages:**

- ▶ Improved design with independent hydraulic connection;
- ▶ Excellent weight/power ratio, which facilitates handling and installation;
- ▶ 80mm-deep, ideal for any environment;
- ▶ Resistant over time, thanks to its double layer coating by anaphoresis with powder finish;
- ▶ 100% made in Italy;
- ▶ Nominal pressure: 16 bar;
- ▶ 100% pressure tested at 24 bar;
- ▶ Burst pressure: 60 bar;
- ▶ Greater heat exchange = outstanding performances, low power consumption.

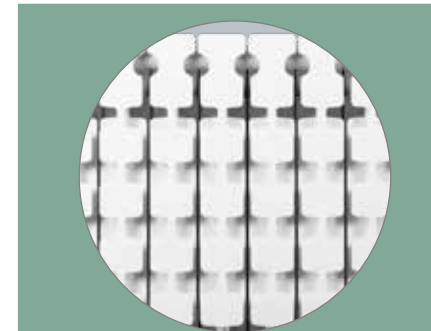

Openings on the rear side

**Choose the Calidor80 radiator, install the product of the future:**

The openings at the rear of the radiator increase convective heat exchange.



Fondital guarantees Calidor80 for 10 years from the date of installation against all production defects providing the heating system is conform to the regulations, in compliance with the standards in force and provided the instructions on installation, use and correct maintenance supplied with the product have been observed.