

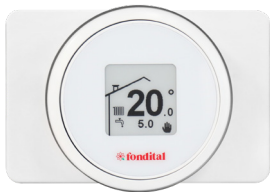

SPOT SMART THERMOSTAT

INSTALLATION, USE

SPOT EASY Thermoregulator



EN

Translation of the
original instructions
(in Italian)

Thank You for choosing and buying one of our products. Please read these instructions carefully in order to properly install, operate, and maintain the product.



WARNING: this instruction manual is an integral and essential part of the product. It shall be supplied by the installer to the user who shall keep it carefully to consult it whenever necessary. This document shall be supplied together with the equipment in case the latter is sold or transferred to others. Use for purposes other than those specified in this manual is not permitted. All installation or maintenance operations must be carried out by qualified personnel. The manufacturer cannot be held responsible for any damage to persons, animals and/or property caused by improper use of the product or failure to comply with these instructions. The manufacturer reserves the right to modify the products and/or its components as deemed necessary, in any moment and without prior notice.



WARNING: do not expose the chronothermostat to heat sources or direct sunlight during use.



WARNING: the chronothermostat must be installed at a height of less than 2 meters from the floor.



WARNING: the chronothermostat cannot be installed outdoors.



WARNING: the chronothermostat cannot be installed at a distance of less than 20 cm from the human body.



DANGER: during cleaning, maintenance, and electrical connection operations, it is mandatory to disconnect the power supply to the chronothermostat and the boiler.



DANGER: do not carry out operations that involve removing the appliance from its installation.



DANGER: do not use the appliance for purposes other than for domestic use or similar.



DANGER: do not use insecticides, solvents or aggressive detergents to clean the appliance.



WARNING: this device may be used by children aged 8 years and above and by persons with reduced physical, sensory, or mental capabilities, or lack of experience and knowledge, provided they are supervised or have been instructed on the safe use of the device. Children shall not play with the device or carry out cleaning operations unless they have been properly instructed beforehand.



WARNING (APPLIANCE DISPOSAL): once the electronic appliance comes to the end of its life, it must be disposed of in compliance with the regulations in force (WEEE waste from electrical and electronic equipment) and in respect of the environment. If in doubt, contact the appliance manufacturer's representative in your country.

The product complies with the essential requirements of the following European Directives and Regulations:

- RED DIRECTIVE 2014/53/EU
- ROHS DIRECTIVE 2011/65/EU
- DELEGATED REGULATION (EU) No. 811/2013
- **SPOT EASY Thermoregulator:** consists of a thermostat capable of controlling a heating zone.

To control additional heating zones, it is necessary to add other SPOT EASY Thermoregulators to the SPOT EASY Thermoregulator. A maximum of four heating zones can be managed.

THERMOSTAT CHARACTERISTICS

Dimensions:	diameter: 70mm, thickness 35mm
Colour:	White, with coloured rubber rings
Wireless technology:	Wi-Fi 802.11 b/g/n 2.4 GHz
Reading range:	0°C to 40°C
Reading accuracy:	+/- 0.1 K
Setting range:	5°C to 30°C
Temperature increase range:	0.5 K
Power supply:	5 V DC with USB-C connector
Fastening:	Screws and wall plugs for the bracket

RADIO RELAY FEATURES

Power supply	230Vac + 10%-15%
Frequency	50/60Hz
Relay dry contact (gateway relay only)	230Vac 0.5A cos phi 1max
Relay live contact (radio relay only)	230Vac 10A cos phi 1max
Communication with boiler (gateway only)	wired bus
Wi-Fi radio communication	802.11 b/g/n (2.4Ghz)
Operating ambient temperature	0 ÷ +40 °C
Storage ambient temperature	-10 ÷ +50 °C
Protection class	IP20
Transmission power	100mW
Power Consumption	2W





PRODUCT DATA SHEET

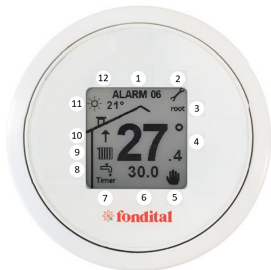

Supplier Name	FONDITAL
Supplier Identification Model	SPOT EASY
Temperature control class	V
Energy efficiency contribution % for space heating	+3%
By adding an external probe:	
Temperature control class	VI
Energy efficiency contribution % for space heating	+4%
In a 3-zone system with 3 sensors:	
Temperature control class	VIII
Energy efficiency contribution % for space heating	+5%

THERMOSTAT INSTRUCTIONS

Thermostat description



KEY:		
1	-	failure display area
2		technical support enabling
3	-	Local network information
4	-	ambient temperature
5		progr. thermostat in manual mode
5		progr. thermostat active
5		progr. thermostat partially active
6	-	set temperature

KEY:		
6	OFF	Heating and domestic hot water disabled
7	TIMER	Domestic hot water timer active
8		Domestic hot water enabled
9		Heating enabled
10		Heating request in progress
11	-	weather
12	-	outside temperature

Navigation gestures:

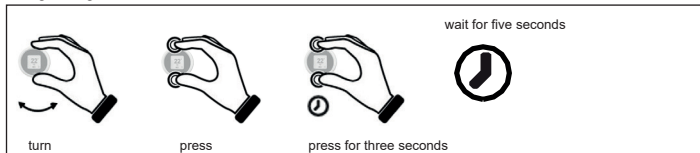

Set temperature

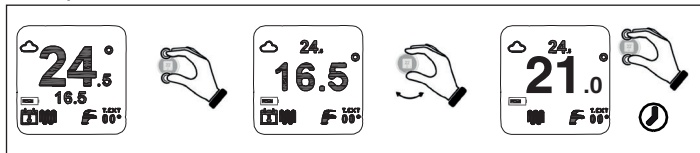

Set programmable thermostat function

day of the week
clicking changes the day
of the week

TIME	T°
06:45 - 08:00	20.0°
08:00 - 16:00	18.0°
16:00 - 21:00	20.0°
21:00 - 24:00	18.0°

copy whole day
paste whole day
exit

schedule
on/off

OFF		
LV	10:45 - 10:45 13:00 - 24:00	schedule Monday-Friday
SD	08:15 - 13:00 14:15 - 24:00	schedule Saturday-Sunday



How to select and set the time:

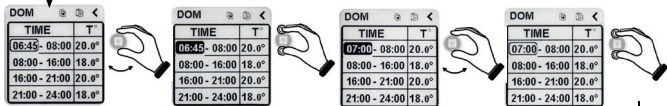

How to select and set the temperature:

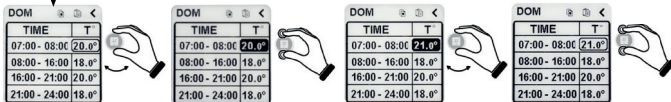

Operating mode

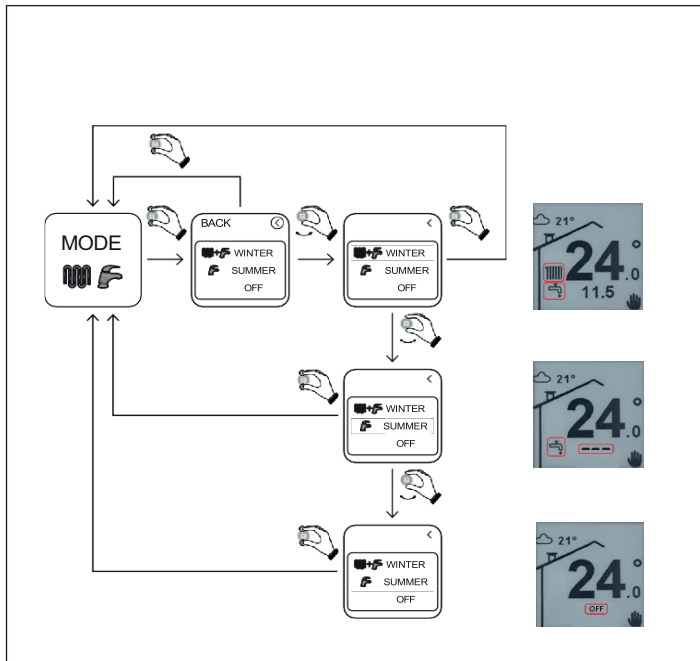

CH temperature setting

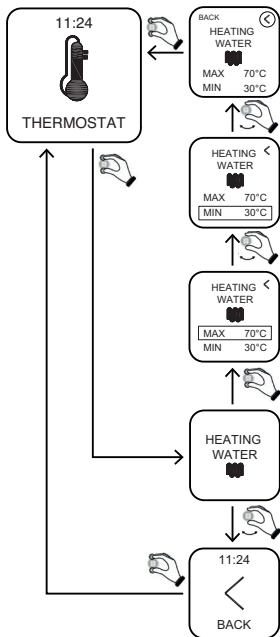

MIN: is the minimum temperature of the heating water that the boiler will provide in modulating operation

(regulation type=room temp /external temp/ room-external).

MAX: is the maximum temperature of the heating water that the boiler will provide in modulating operation

(regulation type=room temp /external temp/ room-external).

MAX: is the maximum temperature of the heating water that the boiler will provide in static operation

(regulation type=on/off).

DHW temperature setting

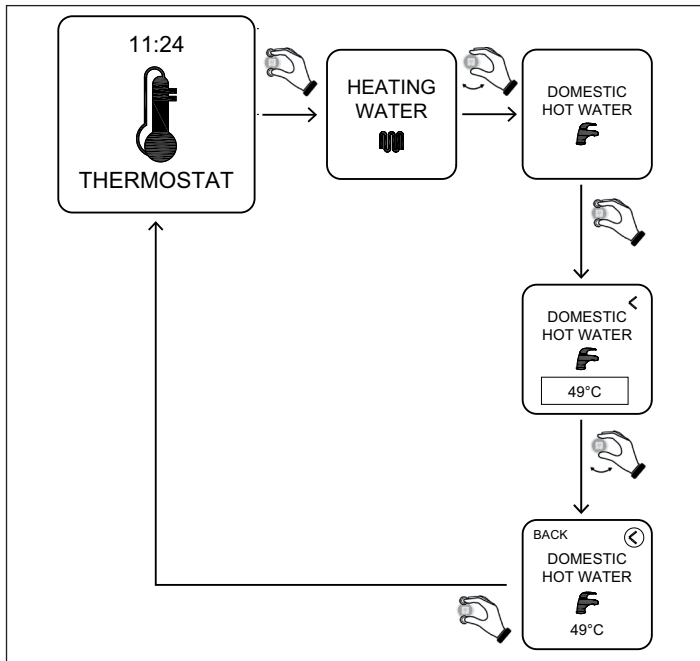

DOMESTIC HOT WATER: the boiler will produce domestic hot water at the temperature set with this parameter.

Setting of differential - antifreeze temperature - probe correction

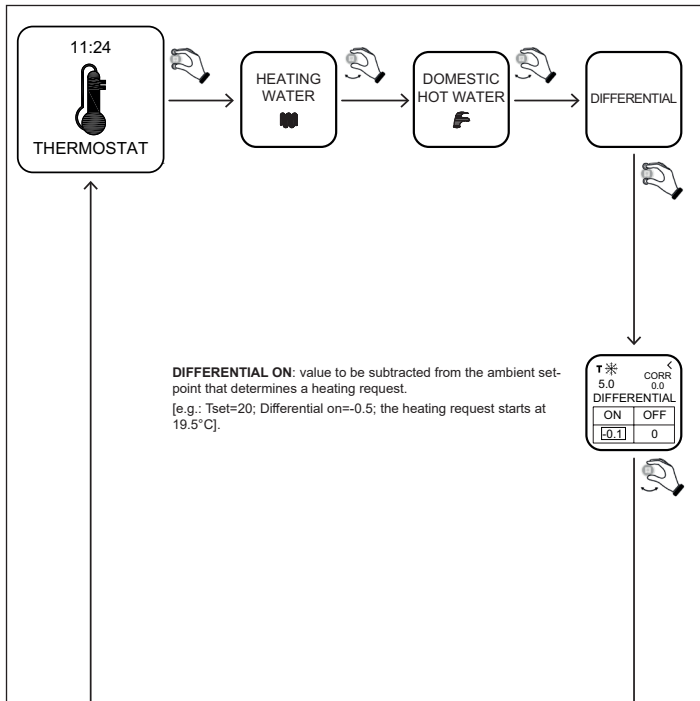

DIFFERENTIAL OFF: value to be added to the ambient set-point that determines the end of heating.

[e.g.: Tset=20; Differential off=+0.5; the heating request stops at 20.5°C].



τ *	CORR	<
5.0	0.0	
DIFFERENTIAL		
ON	OFF	
-0.1	0	



CORR: ambient probe correction. Value to add / subtract to offset any error.

Antifreeze: is the ambient temperature under which an antifreeze request is triggered regardless of the operating mode.

τ *	CORR	<
5.0	0.0	
DIFFERENTIAL		
ON	OFF	
-0.1	0	



Setting the type of regulation of hot water for heating

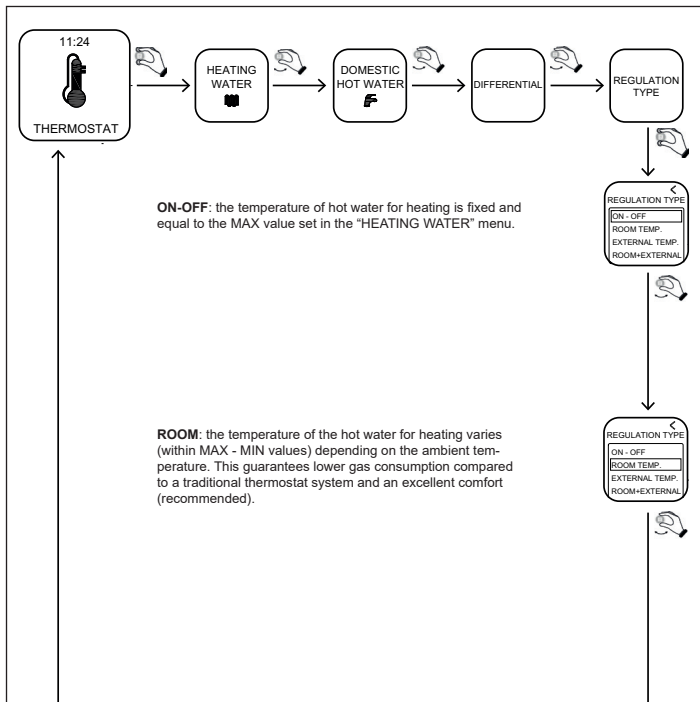

EXTERNAL: the temperature of the hot water for heating varies (within MAX - MIN values) depending on the external **temperature**. This guarantees lower gas consumption compared to a traditional thermostat system.

ROOM + EXTERNAL: the temperature of the hot water for heating varies (within MAX - MIN values) depending on the external temperature and the ambient temperature.



Setting the regulation curve of hot water for heating (to be made by the installer)

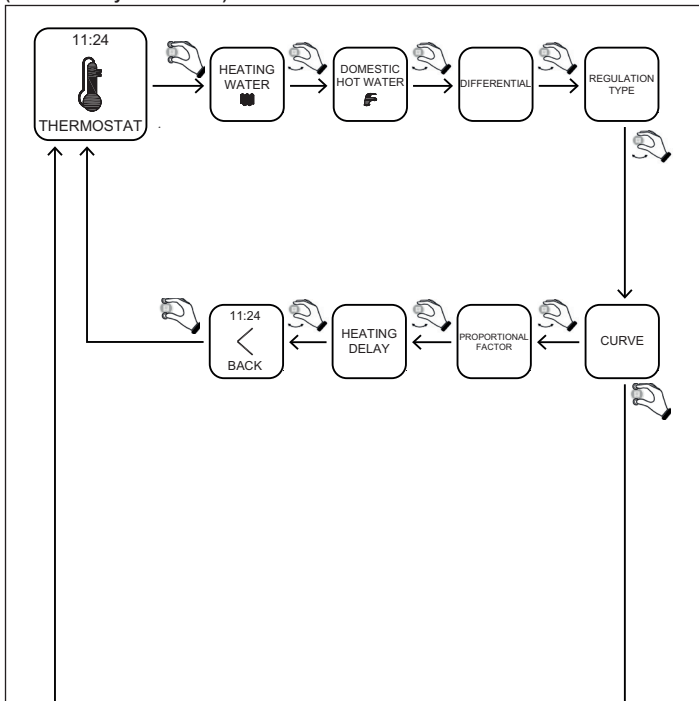

CURVE: this parameter affects the relation between external temperature and heating water temperature. The range goes from 0 to 3. The higher the value, the greater the influence of the external temperature. Values between 0.1 and 0.9 are values for floor systems. Values between 1 and 3 are values for radiator systems. Usually, it is possible to set curves=0.6 for floor systems and curves=1.5 for radiator systems.

The value 0 must be set on the thermostats of the zones where auxiliary zone boards are installed.

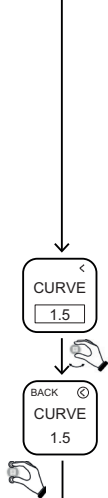

Proportional factor setting (by the installer)

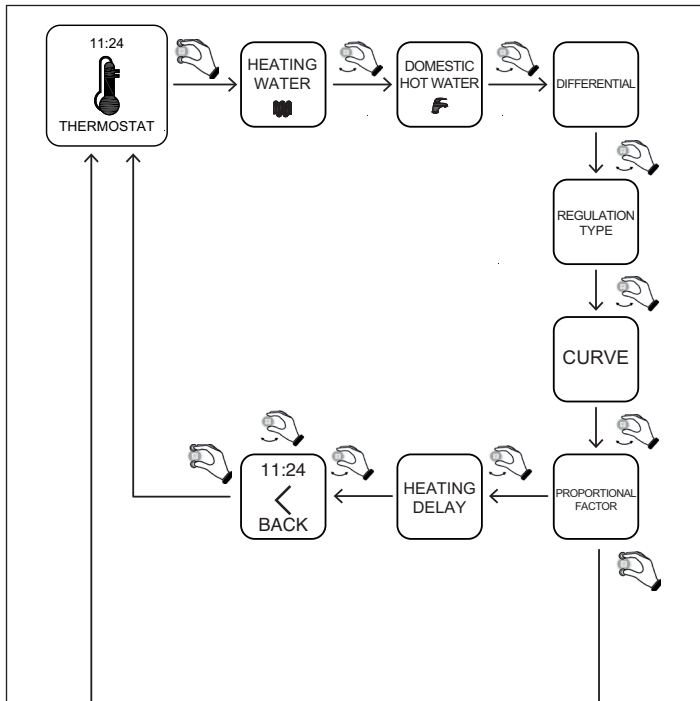

PROPORTIONAL FACTOR: this parameter affects the relation between external/ambient temperature and heating water temperature. The range goes from 0 to 20. The higher the value, the greater the influence of the external/ambient temperature. Recommended value: 8.



Heating delay setting (by the installer)

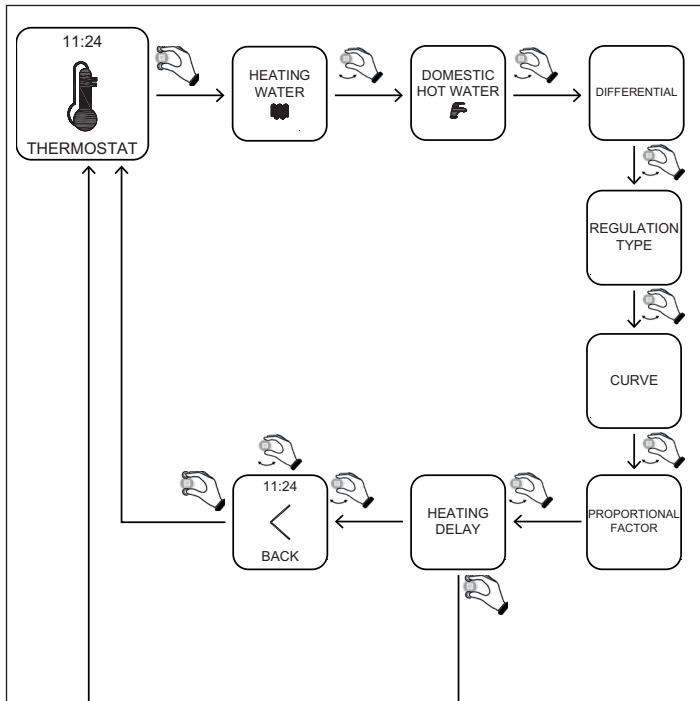

HEATING DELAY: with this parameter you delay the boiler ignition to allow the zone valves to open. At the end of a heating request, it is the zone valve that closes late to ensure correct post-circulation to the boiler pump.

The installer is asked to check the opening time in the characteristics of the valve and to set the Heating delay to the same value [do not set below 30 seconds].

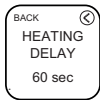
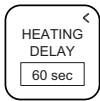

Room temperature offset

If the temperature read by the room sensor requires a correction, it is possible to access and modify the offset parameter in the sub-menu THERMOSTAT->OFFSET. The default value is 0. The offset can be set from a minimum of -5 to a maximum of +5. This parameter is added to the value read by the room sensor.

App – Webapp

The chronothermostat can also be controlled remotely via the MYSPOT PLUS app, available for download from the Google Play Store and Apple Store. For installation and registration procedures, refer to the installation instructions.

Technical support enabling

From the "settings" page, the user can enable or disable the remote control of the boiler and heating system by the Fondital technical support.

THERMOSTAT INSTRUCTIONS

Thermostat description



Front

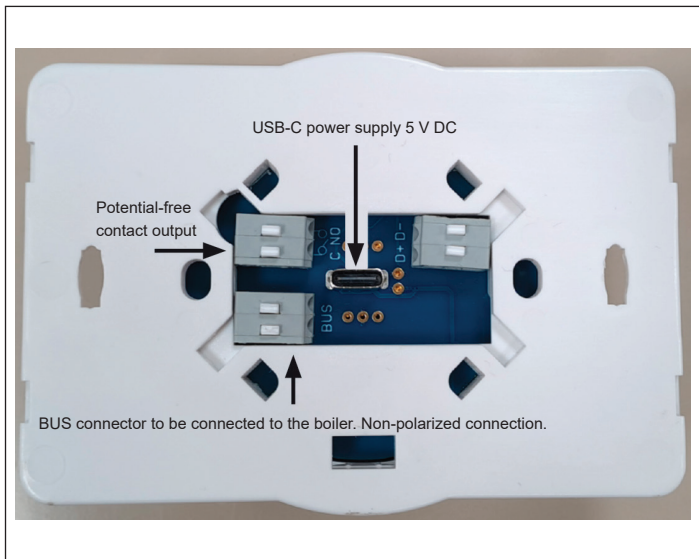

Back

Connection



SAFETY WARNINGS: The connection and installation of electrical devices must be carried out only by professionally qualified personnel, in compliance with national regulations and current safety standards. Any intervention or modification to the device will immediately void the warranty. For connecting the power connector, refer to the photo above and the electrical diagrams described later. The thermostat must be powered exclusively using the power cable supplied with the product. The connection between the boiler and the thermostat is made between the 2-pole “BUS” terminals on the thermostat and the terminals on the boiler intended for connection to the “remote control.”

First connection

Firstly, disconnect the power supply before carrying out any electrical and connection work on the boiler.

- Connect the thermostat power supply so that it is in parallel with the boiler power supply, downstream of the same bipolar switch (**IT IS IMPORTANT THAT THE THERMOSTAT AND THE BOILER TURN ON AT THE SAME TIME**).
- Connect the thermostat's potential-free open contact to properly control the zone valve. Check the valve's manual for the control diagram.
- Connect the communication port to the boiler terminals intended for the “remote control” connection; the two wires are non-polarized **WARNING: only one thermostat should be connected to the boiler, the others communicate with it.**

Once the connections have been made, restore the mains voltage.



WARNING: the connection between the thermostat and the boiler is indicated by the word “CON” on the boiler display (except for boilers “Minorca/Nibir” – “Maiorca/Vega” – “Delfis/Ischia/Antea/Perl” – “Tenerife/Leo”).

Connect the thermostat to a Wi-Fi network (account connection).



WARNING: Before performing this operation, make sure you have the password details of the WiFi network you want to connect to and be sure that this network has an internet connection.

First, download the SPOT PLUS app. Complete the registration in the app. On the thermostat connected to the boiler, go to the menu SETTINGS -> WIFI, then click on PROVISIONING.

The thermostat will display PROVISIONING until the Wi-Fi network is selected in the APP. After that, the main screen will reappear.

1. Wi-Fi Network Connection



Go back to the app and press "NEXT". Choose the Wi-Fi network to which you want to connect the Gateway and type the correct password. After connecting to the cloud, the message indicating the presence of a new Spot will appear. Type the name you want to give to your thermostat and press "SAVE DEVICE".



Change the thermostat's Wi-Fi network



WARNING: Before performing this operation, make sure you have the password details of the WiFi network you want to connect to and be sure that this network has an internet connection.

On the thermostat connected to the boiler, go to the menu SETTINGS -> WIFI, then click on PROVISIONING.

The thermostat will display PROVISIONING until the Wi-Fi network is selected and the corresponding password is entered in the APP. After that, the main screen will reappear.

1. Change Wi-Fi Network

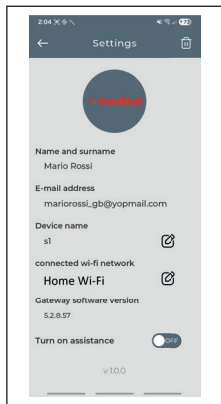
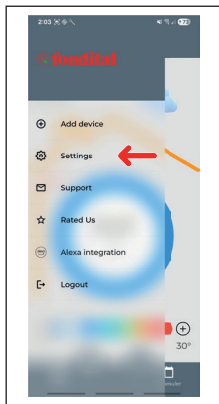
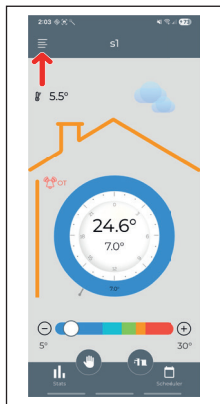

Go back to the app and press "NEXT". Choose the Wi-Fi network to which you want to connect the Gateway and type the correct password. After connecting to the cloud, the message indicating the presence of a new Spot will appear. Type the name you want to give to your thermostat and press "SAVE DEVICE".

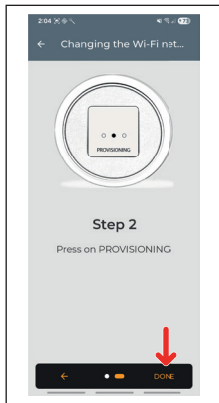
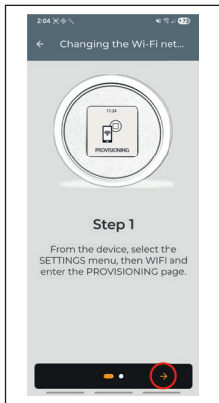

Wi-Fi Relay Connection



The relay is modified according to Fondital's specifications, use only the relay of the Spot Expansion package. Fondital declines any responsibility for the use of a relay different from the one contained in the package.

Connect the relay as shown in the figure below:

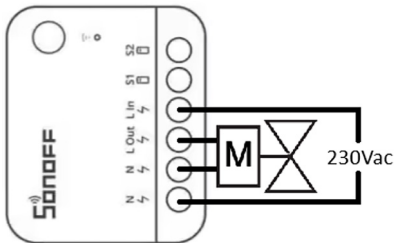

Wi-Fi Relay Pairing

It is possible to pair up to 4 Wi-Fi relays with each thermostat.

To pair a Wi-Fi relay with a thermostat, proceed as follows:

- Power the relay you want to pair, making sure to disconnect those that have not yet been paired.
- Press and hold the button on the relay for 10 seconds. The LED now flashes once every 2 seconds.
- On the thermostat, go to the SETTINGS menu
- Proceed to the WIFI menu
- Proceed in the ADD RELAY menu
- Click on RL1 ADD
- Click on the JOTTO RL item in the list

Expansion of the number of zones (pairing new thermostats)

- On the first thermostat, the one connected to the boiler, enter the SETTINGS menu
- Proceed to the WIFI menu
- Proceed to the LOCAL NETWORK menu
- Proceed to the CONFIGURE menu
- Click on ENABLE AP; information is displayed, including the MAC ADDRESS
- On the thermostat to be paired, enter the SETTINGS menu
- Proceed to the WIFI menu
- Proceed to the LOCAL NETWORK menu
- Proceed to the CONFIGURE menu
- Click on CONNECT TO...
- Click on START SEARCH and wait
- Select the item showing the MAC ADDRESS of the first thermostat and wait
- The number of the zone to which the thermostat has been assigned is displayed
- Click on continue to complete the procedure

Simplified EU Declaration of conformity

The manufacturer **FONDITAL S.p.A.** declares that the type of radio equipment **SPOT EASY thermostat starter kit, SPOT EASY Wi-Fi thermostat expansion kit** complies with Directive 2014/53/EU.

The full text of the EU Declaration of conformity is available at the following Internet address: www.fondital.com



0 L I B R M U L 1 7

Fondital S.p.A. - Società a unico socio
25079 VOBARNO (Brescia) Italy - Via Cerreto, 40
Tel. +39 0365 878 31
Fax +39 0365 878 304
e-mail: info@fondital.it
www.fondital.com

The manufacturer reserves the right to modify his/her products as deemed necessary, without altering the basic characteristics of the products themselves.